

The wall-brackets are used for fixing **copper pipes**. They are easy to assemble and disassemble, allowing for pipe dilation.
Made with an oval hole or with thread M6, with/without a shackle.
Made of PP/PA, max. thermal resistance 110 °C.



Part No.	Size [mm]	Pieces per bag	Pieces per package	Packaging weight [kg]
BRACKET WITH A CLIP				
1K015B	15	50	1000	4,20
1K018B	18	50	500	3,10
1K022B	22	50	500	3,70
1K028B	28	50	500	5,50



BRACKET WITH A CLIP AND METAL NUT M6-Z				
Z1K015B	15	50	1000	6,10
Z1K018B	18	50	500	4,50
Z1K022B	22	50	500	5,10
Z1K028B	28	50	500	6,90



TWIN-BRACKET WITH A CLIP				
2K015B	2x15	50	500	5,30
2K018B	2x18	50	500	5,80
2K022B	2x22	50	400	5,40
2K028B	2x28	50	250	4,40



TWIN-BRACKET WITH A CLIP AND METAL NUT M6-Z				
Z2K015B	2x15	50	500	6,70
Z2K018B	2x18	50	500	7,20
Z2K022B	2x22	50	400	6,30
Z2K028B	2x28	50	250	5,00



BRACKET				
10010Cu	10	50	2000	9,00
10012Cu	12	50	1000	5,40
10015Cu	15	50	1000	5,40
10018Cu	18	50	1000	6,80
10022Cu	22	50	1000	7,70



BRACKET WITH A METAL NUT M6-Z				
Z10012Cu	12	50	1000	7,10
Z10015Cu	15	50	1000	8,20
Z10018Cu	18	50	1000	9,50
Z10022Cu	22	50	1000	10,40



TWIN-BRACKET				
20012Cu	2x12	50	500	5,30
20015Cu	2x15	50	800	9,40
20018Cu	2x18	50	400	6,00
20022Cu	2x22	50	500	8,60

Part No.	A [mm]	B [mm]	C [mm]	D [mm]	E [mm]
----------	--------	--------	--------	--------	--------

BRACKET WITH A CLIP

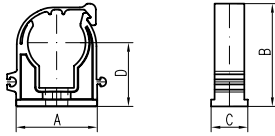

1K015B	28,9	30,8	15,7	20,8	
1K018B	32,2	34,5	15,8	22,2	
1K022B	37,4	39,7	15,7	25	
1K028B	45,5	46,5	15,7	28	

BRACKET WITH A CLIP AND METAL NUT M6-Z

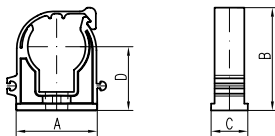

Z1K015B	28,9	30,8	15,7	20,8	
Z1K018B	32,2	34,5	15,8	22,2	
Z1K022B	37,4	39,7	15,7	25	
Z1K028B	45,5	46,5	15,7	28	

TWIN-BRACKET WITH A CLIP

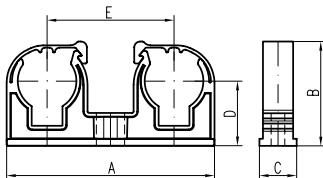

2K015B	56	30,9	15,7	20,5	34,8
2K018B	65,4	34,4	15,7	22,2	40
2K022B	75,5	42,2	15,7	27,4	45
2K028B	91,4	46,4	15,6	27,7	52,7

TWIN-BRACKET WITH A CLIP AND METAL NUT M6-Z

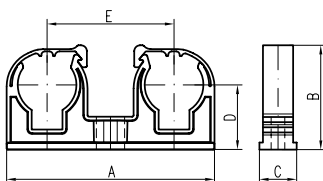

Z2K015B	56	30,9	15,7	20,5	34,8
Z2K018B	65,4	34,4	15,7	22,2	40
Z2K022B	75,5	42,2	15,7	27,4	45
Z2K028B	91,4	46,4	15,6	27,7	52,7

BRACKET

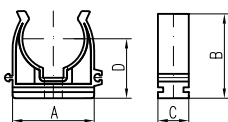

10010Cu	24,5	23,5	15,8	17,8	
10012Cu	28,2	28,5	15,7	19,9	
10015Cu	29,8	30,3	15,7	20,6	
10018Cu	33,6	31,5	15,8	22,3	
10022Cu	38,7	35	15,7	24,7	

BRACKET WITH A METAL NUT M6-Z

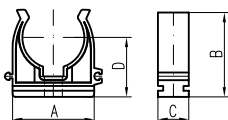

Z10012Cu	28,2	28,5	15,7	19,9	
Z10015Cu	29,8	30,3	15,7	20,6	
Z10018Cu	33,6	31,5	15,8	22,3	
Z10022Cu	38,7	35	15,7	23,9	

TWIN-BRACKET

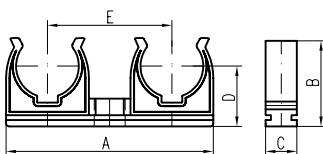

20012Cu	51,6	28,8	15,8	21,1	33,1
20015Cu	58,1	32,2	15,8	22,7	35,9
20018Cu	67,2	33,9	15,8	24,2	40,9
20022Cu	75,6	39,7	15,8	26,2	44,9