

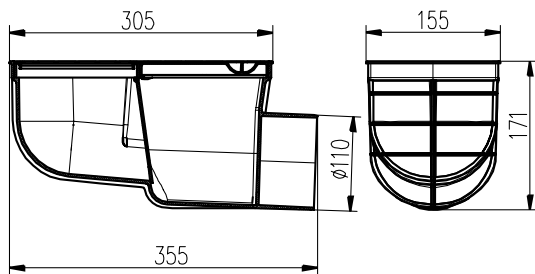

SIDE STREET DRAIN D 110 – STANDARD

The product is designed for draining storm water (surface) water to exterior sewage lines, allowing for rain pipe installations. It includes a dry anti-odour flap, which blocks the odour spreading from the sewage pipeline. The street drain KV 110 B is used for the lowest depth within the sewage system. The eccentric cover in the STANDARD model allows for cut-outs as needed, with diameters 75, 80, 90, 100, 110 or 125 mm. Made of UV-stabilised polypropylene. Loading capacity K3 – 300 kg, resistance to 90 °C, standard EN 1253 – 1.

Part No.	Name	Packaging/Pallet [pcs]	Flow rate [l / min]	Weight [kg / pcs]	Colour
325 G	KV 110 B ST	4 / 120	375	1,05	■
325 G s	KV 110 B ST-s	4 / 120	375	1,05	■



gray



SIDE STREET DRAIN D 110

The product is designed for draining storm water (surface) water to exterior sewage lines, allowing for rain pipe installations. It includes a dry anti-odour flap, which blocks the odour spreading from the sewage pipeline. The street drain KV 110 B is used for the lowest depth within the sewage system. The set is supplied including reduction rings 75/80, 90, 100, 110, 125 and inlet grid. Made of UV-stabilized polypropylene. Loading capacity K3 – 300 kg, resistance to 90 °C, standard EN 1253 – 1.

Part No.	Name	Packaging/Pallet [pcs]	Flow rate [l / min]	Weight [kg / pcs]	Colour
325 D	KV 110 B	4 / 120	375	1,14	■
325 D s	KV 110 B-s	4 / 120	375	1,14	■

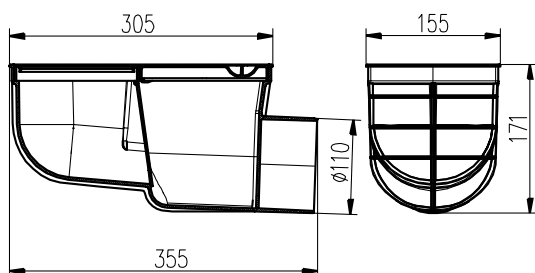

gray